

Prime Retail Space Ready for Lease Immediately

Conveniently situated at the foot of City Creek Center's west staircase, this fresh space is ready for its next big thing. Direct proximity to City Creek Center, Abravanel Hall, and Temple Square makes this a highly visible, heavily visited location.

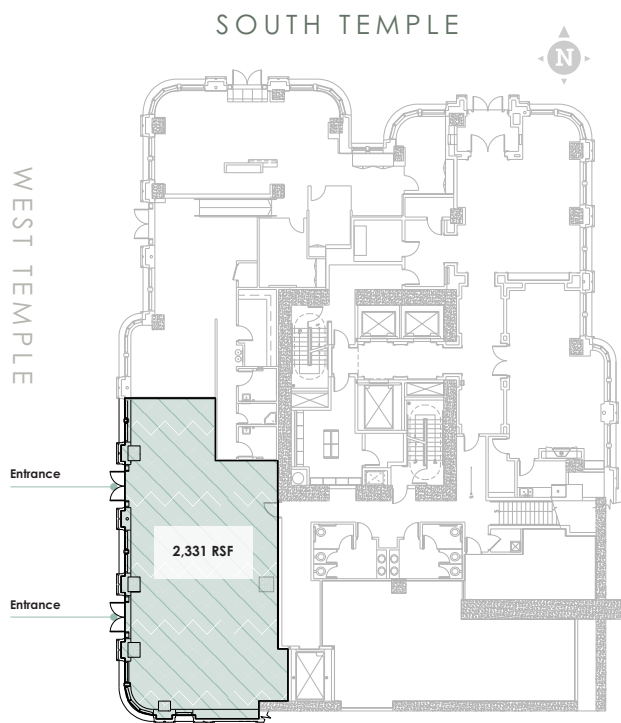

FEATURES OF THE SPACE

2,331 square feet

Main entrance located on West Temple on first floor of the 99 West Condominiums

Two entrances

Direct access to City Creek Center

900-1,100 office workers daily

Floor to ceiling glass lobby

Unfinished interior ready for tenant build out

Abundant natural light

Jordan D. Johnson

801.321.8711

Jordan.Johnson@pripd.com

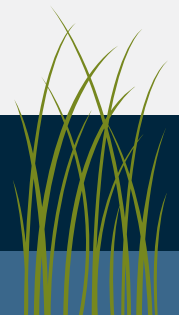

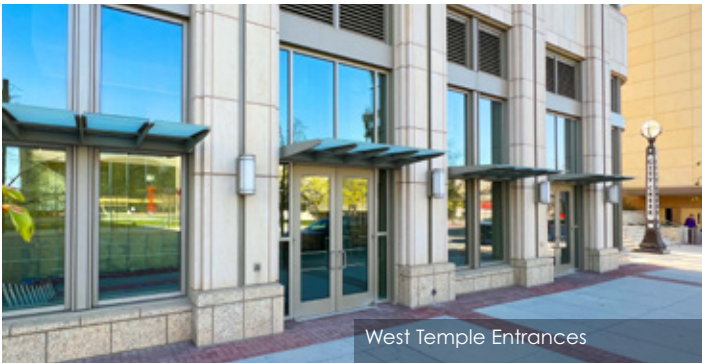

West Temple Entrances



South Exterior



Unfinished Interior



Unfinished Interior

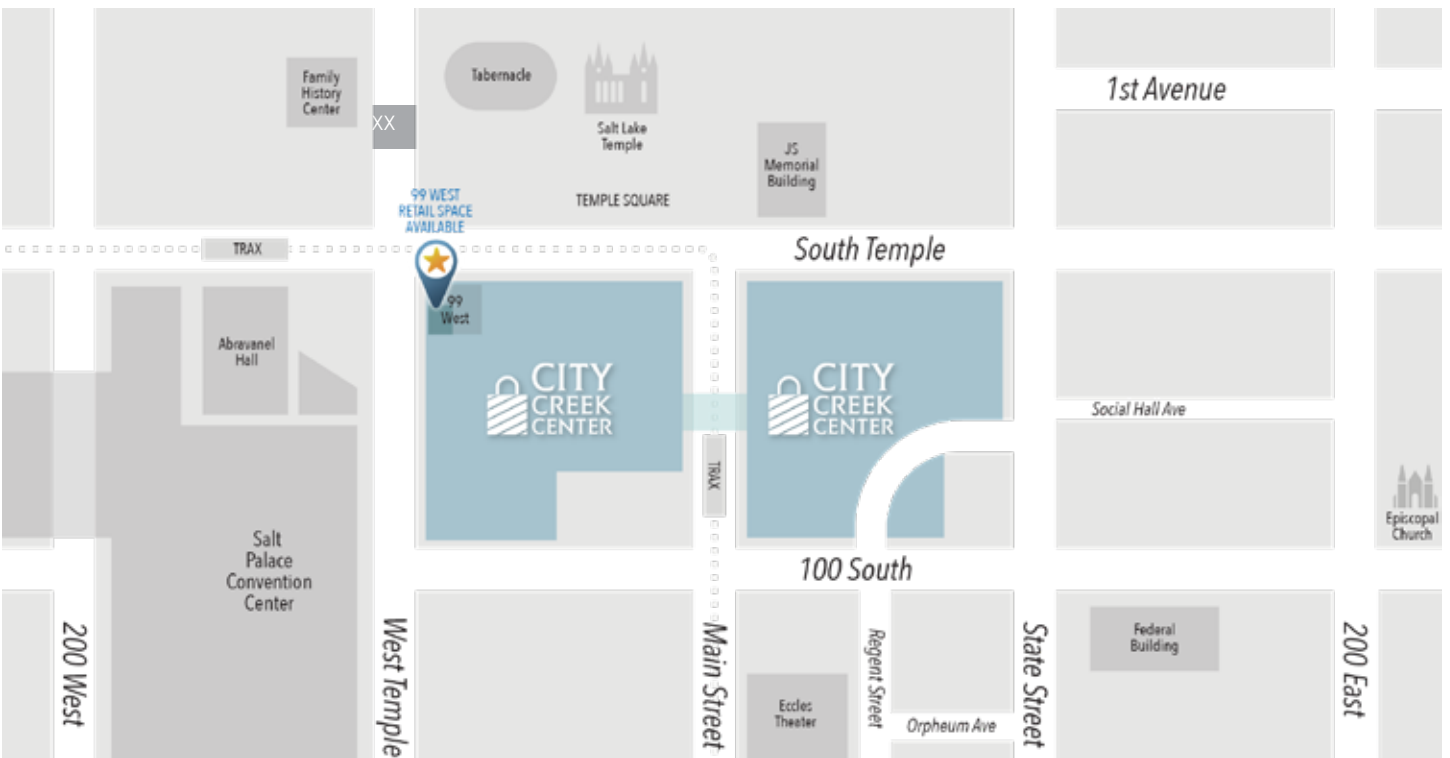

60,000
office workers within
walking distance

750,000
visitors each year

A Part of City Creek, the Center of Downtown

Located in the cultural and central core of downtown Salt Lake City, City Creek is a four block collection of arts, living, entertainment, and office space that brings an eclectic mix of individual to its sidewalks daily.

